









# S-VISOR (SLP-V)

## Protective Face Shield



### Characteristics

-  **Adjustable strap**  
Flexible material, suitable for skin contact and with several adjustment points.
-  **Customizable**  
Print of your name or company logo.
-  **Easy disinfection**  
Easily disinfectable product.
-  **Higher protection**  
Ergonomic design of the visor protects the user against undesirable particles.
-  **Light and comfortable**  
Stability during the use and excellent optical properties. Ideal for extended usage.
-  **One size**  
Adapted for man and woman.

-  **Resistant**  
Unbreakable and long-lasting lens material.
-  **Rotative lens up to 90°**  
Support with several levels of rotation: 0° / 30° / 60° / 90°.
- EN Standards**  
The SLP-V visor was manufactured according to the applicable Harmonized Standards and Regulations, i.e.: standards EN 166 (6.1; 6.2; 6.3; 7.1.1; 7.2.4; 9 and 10) and EN 168 (12 and 18) and Regulation (EU) 2016/425.
-  **Sustainable**  
Reusable and environmentally friendly.

There are no known contraindications to the use of SLP-V Protection Face Shield, however, materials that may come into contact with the user's skin may cause allergic reactions in susceptible individuals.

### Storage and Cleaning

It can be stored and transported in its original packaging at room temperature (0°C to 30°C). Can be stored in dark environments for up to 3 years. **Do not store in places where directly exposed to light and heat.** Clean with warm water, soap and a soft cloth or with a non-abrasive disinfectant solution. **Do not use solvents or abrasives.**

### Assembly Instructions

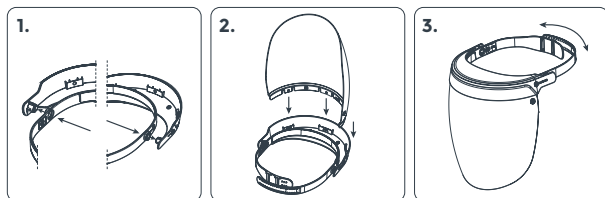

**1.** Fit the adjustable strap to the visor support using the clips.

**2.** Fit the lens to the support (3 clips) – until you hear the "click".

**3.** Fit to head.

### Marking

The SLP-V Protection Face Shield has a marking with the following meaning:

**Marking on the eyepiece:** **3 SOCEM** meaning that these are Protection Face Shield with good colour recognition, manufactured by SOCEM ED, S.A.

**Marking on the support frame:** **SOCEM EN166 3** meaning that these are Protection Face Shield to protect against splashes of liquids, fabricada por SOCEM ED, S.A.

### Validity

If the Protective Face Shield are pitted, scratched or damaged, they must be replaced with an original equivalent.